

Automatic Feeder - Model 300-29X

Replacement Parts

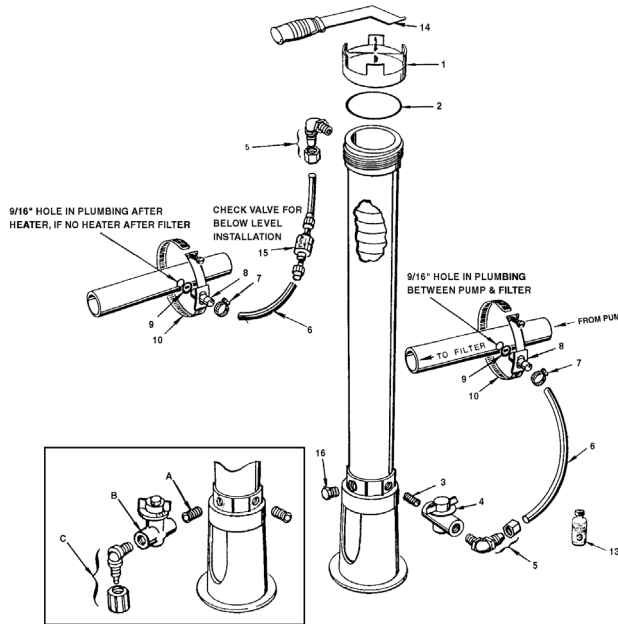

Item	Qty.	Part No.	Description	US List	Can. List
Order No.: R171070 Model No.: 300-29X Description: COMMERCIAL SIZE FEEDER					
1	1	R172008W	3 in. threaded cap, white	15.71	16.18
2	1	R172009	O-ring, cap	5.92	6.10
3	1	R172256	1/2 in. x Short MPT nipple	5.03	5.18
4	1	R172086	1/2 in. Control valve	45.35	46.71
5	2	R172272	1/2 in. 90° NPT x tube fitting w/nut	6.47	6.66
5	Opt.	R172274	Compression nut only (for R172272)	2.37	2.44
6	1	R172269	1/2 in. i.d. Feeder tube, 12 ft.	15.16	15.61
7	2	R175013	S/S tubing clamp	5.03	5.18
8	2	R172262	Saddle tube fitting	5.03	5.18
9	2	R172263	Saddle gasket	1.88	1.94
10	2	R172264	Saddle clamp	9.28	9.56
10A	Opt.	R172264XL	Saddle clamp for 3 in., 4 in. & 6 in. pipe	12.31	12.68
11	1	R172392	1/4 in. MPT PVC plug (old style)	5.03	5.18
13	1	R172036	Silicone lubricant, 3/4 oz.	8.55	8.81
14	Opt.	R172052	Cap wrench	24.25	24.98
15	Opt.	R172324NS	1/2 in. Corrosion resistant check valve, tube x tube (ball)	18.34	18.89

Item	Qty.	Part No.	Description	US List	Can. List
16	1	R172134	1/2 in. MPT PVC plug	5.54	5.71
Order No.: R172275 Parts bag for 300-29X Complete					
3	1	R172256	1/2 in. x Short MPT nipple	5.03	5.18
4	1	R172086	1/2 in. Control valve	45.35	46.71
5	2	R172272	1/2 in. 90° NPT x tube fitting w/nut	6.47	6.66
5	Opt.	R172274	Compression nut only (for R172272)	2.37	2.44
7	2	R175013	S/S tubing clamp	5.03	5.18
8	2	R172262	Saddle tube fitting	5.03	5.18
9	2	R172263	Saddle gasket	1.88	1.94
10	2	R172264	Saddle clamp	9.28	9.56
13	1	R172036	Silicone lubricant	8.55	8.81
Order No.: R172002 Optional Drain Kit					
A		R172256	1/2 in. Short MPT nipple	5.03	5.18
B		R172086	1/2 in. Control valve	45.35	46.71
C		R172272	1/2 in. 90° NPT x tube fitting w/nut	6.47	6.66